

WOOD DESTROYING PESTS AND ORGANISMS INSPECTION REPORT

Building No.	Street, City, Zip	Date of Inspection	No. of Pages
11111	Any Street, Any City, CA, 11111	--/--/--	6
DeANZA TERMITE & PEST CONTROL, INC. P.O. Box 291 Murrieta, CA 92564-0291 Tax ID 33-0826800 (951) 677-8770			
Firm Registration No. PR 3424	Report No. 262551	Escrow No.	
Ordered By: Real Estate Agent	Property Owner/Party of Interest: Homeowner	Report Sent To: Escrow	
COMPLETE REPORT <input checked="" type="checkbox"/> LIMITED REPORT <input type="checkbox"/> SUPPLEMENTAL REPORT <input type="checkbox"/> REINSPECTION REPORT <input type="checkbox"/>			
General Description: One story, stucco framed, residence, concrete slab, tile roof, occupied		Inspection Tag Posted: Garage	Other Tags Posted: None Noted
An inspection has been made of the structure(s) shown on the diagram in accordance with the Structural Pest Control Act. Detached porches, detached steps, detached decks and any other structures not on the diagram were not inspected.			
Subterranean Termites <input checked="" type="checkbox"/> Drywood Termites <input checked="" type="checkbox"/> Fungus/Dryrot <input checked="" type="checkbox"/> Other Findings <input checked="" type="checkbox"/> Further Inspection <input checked="" type="checkbox"/> If any of above boxes are checked, it indicates that there were visible problems in accessible areas. Read the report for details on checked items.			

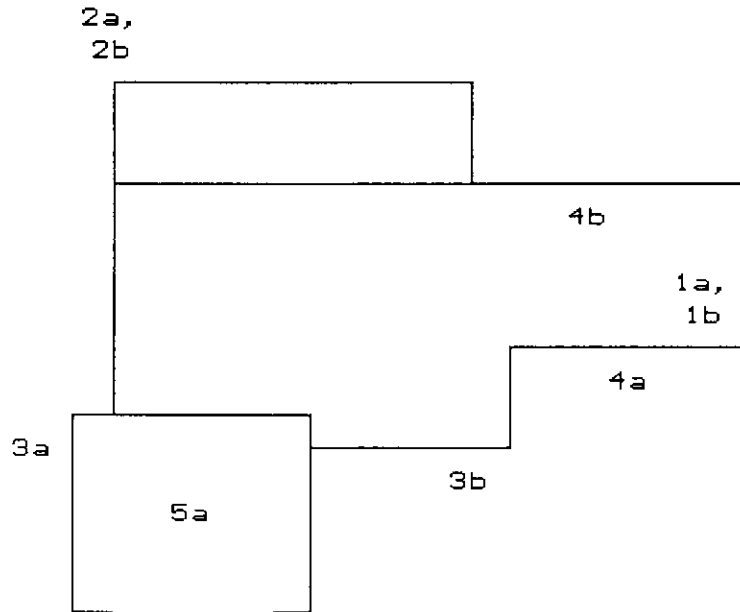

Inspected By _____ License No. _____ Signature _____
 You are entitled to obtain copies of all reports and completion notices on this property reported to the Structural Pest Control Board during the preceding two years. To obtain copies contact : Structural Pest Control Board, 1418 Howe Avenue, Suite 18, Sacramento, California 95825-3204.

NOTE: Questions or problems concerning the above report should be directed to the manager of the company. Unresolved questions or problems with services performed may be directed to the Structural Pest Control Board at (916) 561-8708, (800) 737-8188 or www.pestboard.ca.gov. 43M-41 (Rev. 10/01)

11111 Any Street, Any City, CA, 11111

--/--/--

262551

BUILDING NO. STREET, CITY, STATE, ZIP

INSPECTION DATE REPORT NO.

There are certain areas of a structure which are considered impractical for inspection: the interior of hollow walls, spaces between a floor or porch deck. Stall showers over finished ceilings, abutments or floors beneath coverings are considered inaccessible and were not inspected at this time. NOTE: Eaves requiring the use of an extension ladder are considered impractical for inspection. Appliances and/or plumbing over finished ceilings and decks are not water tested and we do not certify against leakage, unless otherwise noted in this report. No opinion is rendered, nor guarantee is implied concerning the future watertightness of the roof. This firm makes no guarantee against any infestation, leaks or other adverse conditions which may exist or which may develop in inaccessible areas and become visibly evident after the date of this inspection. This inspection is only on the structures indicated on the diagram. If requested, a reinspection of this property will be performed by this firm at additional cost. The exterior surface of the roof will not be inspected. **If you want water tightness of the roof determined, you should contact a roofing contractor who is licensed by the contractor's state license board.** Our job estimate for work is good for 30 days. The original report is valid for a period of four months.

This Wood Destroying Pests & Organisms Report **DOES NOT INCLUDE MOLD**, fungi or any mold-like conditions. By California law we are neither qualified, authorized nor licensed to inspect for health related molds or fungi. Mold is not a Wood Destroying Organism and is outside the scope of this report as defined by the Structural Pest Control Act. No reference will be made to mold or mold-like conditions. If you wish your property to be inspected for mold-like conditions or you desire information about the presence of health related molds, you should contact an industrial hygienist or the appropriate mold professional.

This company will re-inspect repairs done by others within four months of the original inspection. A charge, if any, can be no greater than the original inspection fee for each re-inspection. The re-inspection must be done within ten (10) working days of request. The re-inspection is a visual inspection and if inspection of concealed areas is desired, inspection of work in progress will be necessary. Any guarantees must be received from parties performing repairs.

11111	Any Street, Any City, CA, 11111	--/--/--	262551
BUILDING NO.	STREET, CITY, STATE, ZIP	INSPECTION DATE	REPORT NO.

IF A SEPARATED REPORT HAS BEEN REQUESTED, IT IS DEFINED AS SECTION 1 & SECTION 2 CONDITIONS EVIDENT ON THE DATE OF INSPECTION.

SECTION 1: CONTAINS ITEMS WHERE THERE IS EVIDENCE OF ACTIVE INFESTATION, INFECTION OR CONDITIONS THAT HAVE RESULTED IN OR FROM INFESTATION OR INFECTION.

SECTION 2: SECTION 2 ITEMS AREA CONDITIONS DEEMED LIKELY TO LEAD TO INFESTATION OR INFECTION, BUT WHERE NO VISIBLE EVIDENCE OF SUCH WAS FOUND.

FURTHER INSPECTION: FURTHER INSPECTION ITEMS ARE DEFINED AS RECOMMENDATIONS TO INSPECT AREAS WHICH DURING THE ORIGINAL INSPECTION, DID NOT ALLOW THE INSPECTOR ACCESS TO COMPLETE THE INSPECTION AND CANNOT BE DEFINED AS SECTION 1 OR SECTION 2.

SUBTERRANEAN TERMITES:

Finding 1A:

Evidence of Subterranean Termites noted at living room wall. Marked 1a on diagram.

Recommendation 1A:

Drill through concrete slab adjacent to infestation. Inject with a state approved solution for the control of subterranean termites. Seal holes. Remove evidence of tubes. (TERMIDOR) (active ingredient: Fipronil) . Local treatment is not intended to be an entire structure treatment method. If infestations of wood-destroying pests extend or exist beyond the area(s) of local treatment, they may not be exterminated.

***** This is a Section 1 Item *****

Finding 1B:

Evidence of Subterranean Termite Damage noted at same living room wall baseboard. Marked 1b on diagram.

Recommendation 1B:

Remove and replace approximately 6' of 2 1/2" baseboard. **Paint white primer-see note.

***** This is a Section 1 Item *****

DRYWOOD TERMITES:

Finding 2A:

Evidence of Drywood Termites noted at patio post. Marked 2a on diagram.

Recommendation 2A:

Chemically treat infested wood members with a state approved solution for the control of drywood termites. Remove or cover pellets. (CY-KICK) (active ingredient: Cyfluthrin) or (TIMBOR) (active ingredient: Disodium Octaborate Tetrahydrate). Local treatment is not intended to be an entire structure treatment method. If infestations of wood-destroying pests extend or exist beyond the area(s) of local treatment, they may not be exterminated.

***** This is a Section 1 Item *****

11111 Any Street, Any City, CA, 11111

--/--/--

262551

BUILDING NO. STREET, CITY, STATE, ZIP

INSPECTION DATE REPORT NO.

DRYWOOD TERMITES:

Finding 2B:

Drywood Termite Damage noted at same post. Marked 2b on diagram.

Recommendation 2B:

Remove and replace approximately 8' of 4" x 4" roughsawn. **Paint green primer-see note.

***** This is a Section 1 Item *****

FUNGUS/DRYROT:

Finding 3A:

Fungus Damage noted at garage service door. Marked 3a on diagram.

Recommendation 3A:

Remove and replace damaged door. Install a new solid hardboard door. Using existing hardware. (32" x 1 3/4") **Paint white primer-see note.

***** This is a Section 1 Item *****

Finding 3B:

Fungus Damage noted at front window trim. Marked 3b on diagram.

Recommendation 3B:

Remove and replace approximately 3' of 1" x 3". **Paint green primer-see note.

***** This is a Section 1 Item *****

OTHER FINDINGS:

Finding 4A:

Faulty Grade noted at front planter. Marked 4a on diagram.

Recommendation 4A:

Lower soil to correct.

***** This is a Section 2 Item *****

Finding 4B:

Excessive Moisture causing Water Damage at shelf below kitchen sink. Marked 4a on diagram.

Recommendation 4B:

Recommendation 1: Remove and replace approximately 2' x 3' of 5/8" particle board. Seal with varnish. **Recommendation 2:** Others to correct moisture condition.

***** This is a Section 2 Item *****

FURTHER INSPECTION:

Finding 5A:

Inaccessible Area noted at interior of garage due to storage. Marked 5a on diagram.

11111 Any Street, Any City, CA, 11111

--/--/--

262551

BUILDING NO. STREET, CITY, STATE, ZIP

INSPECTION DATE REPORT NO.

FURTHER INSPECTION:

Recommendation 5A:

Others to remove storage to allow **this company to further inspect area and report findings and additional costs as needed.**

***** Unknown Further Inspection Recommended *****

** PAINT NOTE: One coat of paint will be applied to all wood where indicated on this report. This initial coat of paint should be considered a primer coat and additional coats should be added. Although, to preserve the aesthetics of your home, color matching will be provided in the cost estimate given unless otherwise stated. This company will use the brand of paint that is standard to us. If the homeowner wishes to supply exact paint to match, credit may be given. Color and sheen are not guaranteed to match.

PESTICIDES ARE THE PRODUCTS DE ANZA TERMITE & PEST CONTROL USES TO CONTROL THE TARGET PEST LISTED IN YOUR INSPECTION. PESTICIDES MAKE A BETTER LIFE FOR ALL OF US. THEY HELP CONTROL DISEASE CARRIERS THUS PROTECTING YOUR HEALTH AND PROPERTY. WHEN PROPERLY USED, PESTICIDES POSE NO PROBLEM TO MAN OR THE ENVIRONMENT. YOUR DE ANZA TERMITE & PEST CONTROL TECHNICIAN IS A STATE CERTIFIED APPLICATOR AND IS CONSTANTLY BEING UPGRADED BY OUR TRAINING SESSIONS. IF YOU HAVE ANY QUESTIONS PLEASE CALL THE FOLLOWING NUMBER: (909) 677-8770.

STATE LAW REQUIRES THAT YOU BE GIVEN THE FOLLOWING INFORMATION: CAUTION PESTICIDES ARE TOXIC CHEMICALS. STRUCTURAL PEST CONTROL OPERATORS ARE LICENSED AND REGULATED BY THE STRUCTURAL PEST CONTROL BOARD, AND APPLY PESTICIDES WHICH ARE REGISTERED AND APPROVED FOR USE BY CALIFORNIA DEPARTMENT OF FOOD AND AGRICULTURE AND THE UNITED STATES ENVIRONMENTAL PROTECTION AGENCY. REGISTRATION IS GRANTED WHEN THE STATE FINDS THAT BASED ON EXISTING SCIENTIFIC EVIDENCE THERE ARE NO APPRECIABLE RISKS IF PROPER USE CONDITIONS ARE FOLLOWED OR THAT THE RISKS ARE OUTWEIGHED BY THE BENEFITS. THE DEGREE OF RISK DEPENDS UPON THE DEGREE OF EXPOSURE, SO EXPOSURE SHOULD BE MINIMIZED.

11111	Any Street, Any City, CA, 11111	--/--/--	262551
BUILDING NO.	STREET, CITY, STATE, ZIP	INSPECTION DATE	REPORT NO.

IF WITHIN 24 HOURS FOLLOWING APPLICATION YOU EXPERIENCE GARBLED SPEECH, SHORTNESS OF BREATH OR SYMPTOMS SIMILAR TO COMMON SEASONAL ILLNESS COMPARABLE TO THE FLU, CONTACT YOUR PHYSICIAN OR POISON CONTROL CENTER AND YOUR PEST CONTROL OPERATOR IMMEDIATELY.

FOR FURTHER INFORMATION CONTACT ANY OR THE FOLLOWING:

DE ANZA TERMITE & PEST CONTROL	- (909) 677-8770
POISON CONTROL CENTER	- (800) 876-4766

	COUNTY HEALTH DEPARTMENT	COUNTY AGRICULTURE
ORANGE	- (714) 834-3155	- (714) 447-7100
RIVERSIDE	- (909) 358-5000	- (909) 955-3000
SAN BERNARDINO	- (909) 387-6280	- (909) 387-2105
SAN DIEGO	- (619) 338-2222	- (858) 694-2741
For Regulatory Information:		
STRUCTURAL PEST CONTROL BOARD		- (800) 737-8188
1418 Howe Avenue, Suite 18, Sacramento CA 95825-3280		